

INFISSO INSERITO NEI PANNELLI DI RIVESTIMENTO

Palahockey - Torino, 2003 - arch. Arata Isozaki & Associates

fonte: Favero & Milan Ingegneria

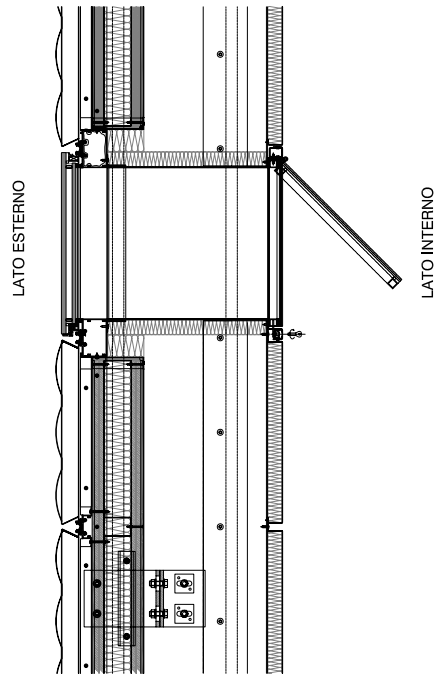

LATO ESTERNO

LATO INTERNO

sezlone verticale

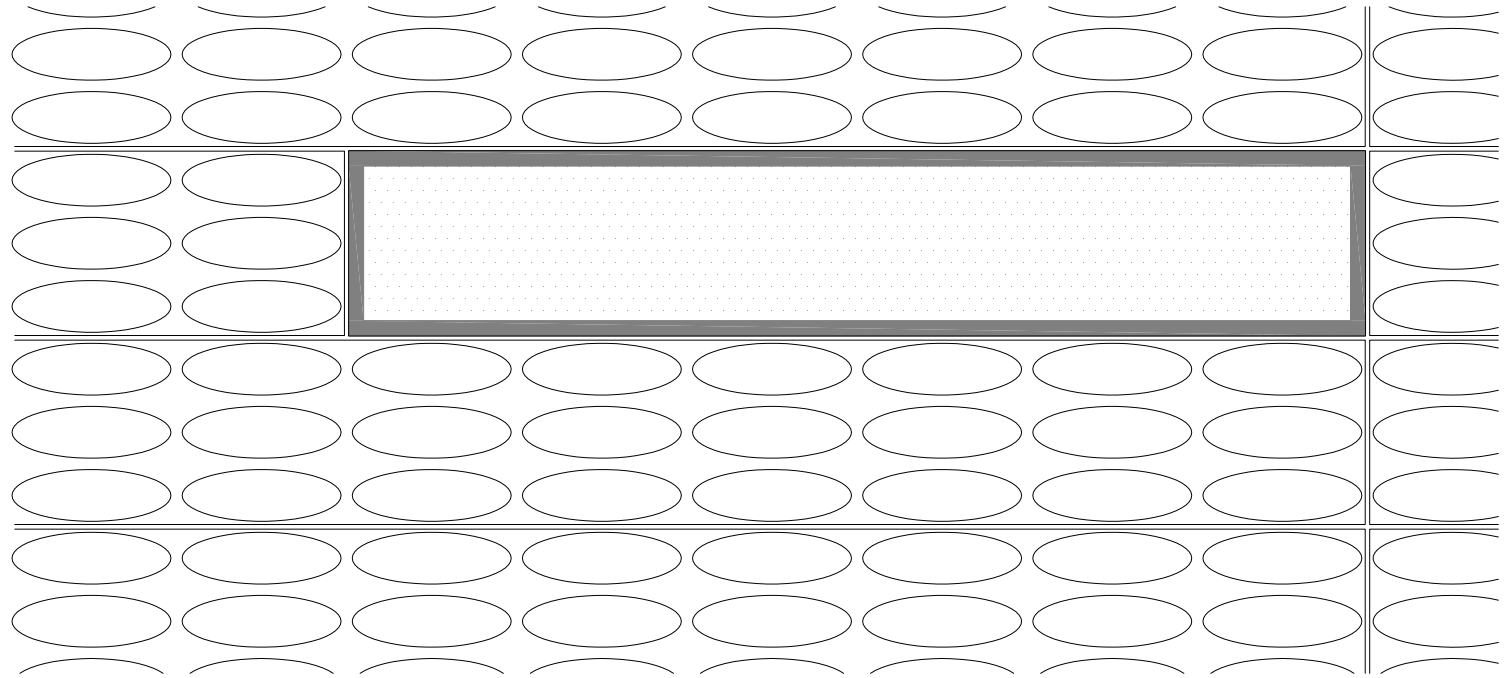

prospetto esterno

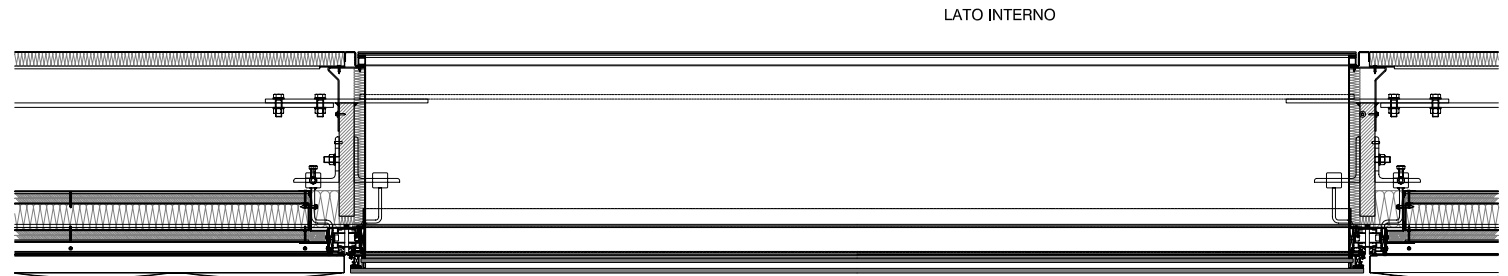

LATO INTERNO

LATO ESTERNO

0 20 40 60 cm scala 1: 20 sezione longitudinale